

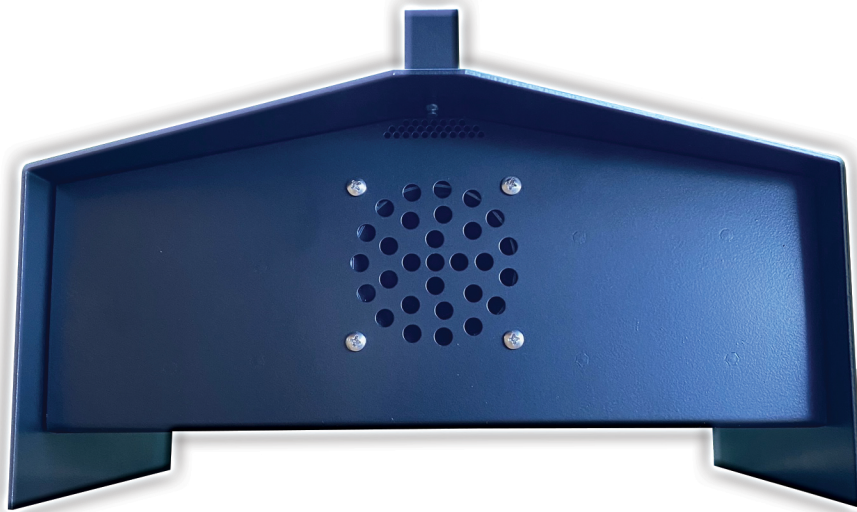

# MIGHTYBOOM USER MANUAL



## **Pigeon Patrol Products and Services**

#301 - 17665 66A Avenue, Surrey, B.C. Canada V3S 2A7

Phone.604.585.9279 • Fax.604.585.9290

1.877.4.NO.BIRD • sales@pigeonpatrol.ca

[www.pigeonpatrol.ca](http://www.pigeonpatrol.ca)



## MIGHTYBOOM USER MANUAL

Before I start with the Instructions, I would like to thank you for purchasing our unit. Sounds and Ultrasonic sounds will deter animals and birds as long as you follow a few simple instructions. You might need to change the Ultrasonic sounds to get the right frequency that will deter the bird or animal. You might get the right one and it could last five to six months, but like most things animals and birds sometimes get used to these sounds and you may need to change the frequency if you find the animal or birds are returning. The audible sounds on the unit work really well. However most of your neighbours and business clients do not want to hear a screeching hawk or owl every hour or so. Most of our clients tend to use the predator and distress sounds for a week or so along with the Ultrasonic sounds to deter the birds. The sounds can be then turned off until such a time that the birds or animals come back and you need to scare them again. However if you are out on a farm or these sounds do not bother your or your neighbours blast away.

One last thing about the unit: We did our research and testing. Most of our competitors are using a small circuit board with a small built in amplifier and four to six sounds. The tweeters that they are using, can be bought for \$0.05 overseas. Most of our competitors will tell you that their unit coverage is 2 to 6 acres. Remember this is not from one tweeter. This is done by using four tweeters with a 100-foot speaker wire each connected to each tweeter to stretch out 400 feet away from the unit. A square acre is about 200 feet long by 200 feet wide depending on the acre. An acre could also be 100 feet long by 300 feet wide. So I do not know what testing or measurements our competitors are using but when we say you will be able to hear our unit with one tweeter, I mean you will be able to hear that sound from one tweeter 1,200 feet away.

With this unit we also tried to have a touch screen monitor build right into the unit. However due to the computer slowing down and risk of water, snow and sun damage that might be caused we decided against it. We have done the research and have invested time and a great deal of money to bring you the best Ultrasonic and Sound unit on the market today.

The MightyBoom has an operating system using the Raspberry Pi (mini computer) with WiFi running as an access point (mini internet). The Raspberry Pi is running an Apache programme (like Windows or Mac) with a web interface that will play ultrasonic frequencies and sounds files into an amplifier that signals into a horn driver tweeter unit.

The system is accessible via any computers, tablets and with most smartphones. **MightyBoom** emits over 100 natural recorded predator, urban, human, bird/animal distress calls and other environment sounds to startle, scare and intimidate birds or animals.

**Choices include:** Pigeon, Seagulls, Crows, Woodpeckers, Small Birds, Deer, Raccoon, Skunks, Small Animals Coyotes, Chipmunk and Squirrels.

**MightyBoom** also plays frequency ranges from 8 kHz to 24 kHz offering 13 different settings.

## INSTRUCTION

### Removing the Unit:

1. Take unit out of the box and unwrap it.
2. Make sure the unit, electrical cord and stand are in the box.

### Setting Up the Unit:

1. Place the unit on the stand either in the desired area of use or near a computer. (Remember after setting up the unit all the settings will be saved inside the units computer. You will then be able to relocate the unit and just plug it in using the same setting.)
2. Plug the electrical cord into the unit and then into the electrical wall socket.
3. Unit will turn on automatically. Units computer will boot up in 30 seconds.

### Linking Up to the Unit:

Using computers, tablets or other smartphone devices:

**(Some Blackberries are not compatible with the unit)**

1. Turn on your computer, tablet or other smartphone and access, in the **Utilities, Settings or Network** section, your





Wi-Fi area. Once in the Wi-Fi area you will be able to choose the Ultrasonic Wi-Fi Network.

2. Choose the UltraSonic Wi-Fi network. What you are doing is really just building a bridge from your computer, tablet or other smartphone to the computer in the unit.
3. On your computer, tablet or other smartphone, go back to the main screen.
4. Now log onto the internet using Safari, Outlook Explorer or any web browser you use.
5. Insert the following numbers into the address bar - **<http://192.168.42.1>**  
(referred to as the location bar or URL bar, the address bar is a name used to describe the text box used to enter a website address or numbers in a web browser.)

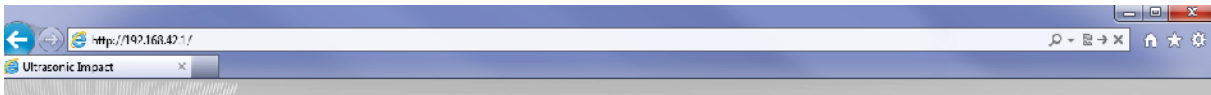

6. You should be asked to insert the user name and password  
User name: **pigeon** Password: **patrol**
7. You will then be logged on to the main page of the UltraSonic Unit and be ready for setting it up.

**Please Note:** The audible sounds are designed to deter new birds or animals from coming into the desired area. The UltraSonic sounds are designed to deter the roosting birds with a constant high pitch frequency. Turning on the unit and pointing it at a bird/animal is not what the unit is made for. This unit takes days or sometimes weeks to permanently deter and remove the birds. However, the unit works right away on small animals and deer.

#### Setting the Time and Date:

1. Set the present time and date and then push the **Set date and time** button to save your selection. (Please note that if the unit is shut down the time and date will have to be reset.)

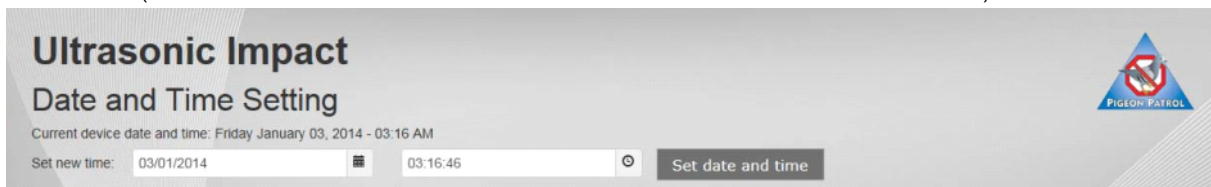

#### Setting the Weekday Start and Finish Time:

1. Select the desired days of the week that you would like to have the unit on.  
(selecting the button select all weekdays will highlight and select all of the days of the week.)
2. Select the desired start time for the unit.
3. Select the desired finish time for the unit.

The start time and finish time will apply for each day of the week that is selected. You do not have to select the start and finish time for each day. The settings will just repeat itself.

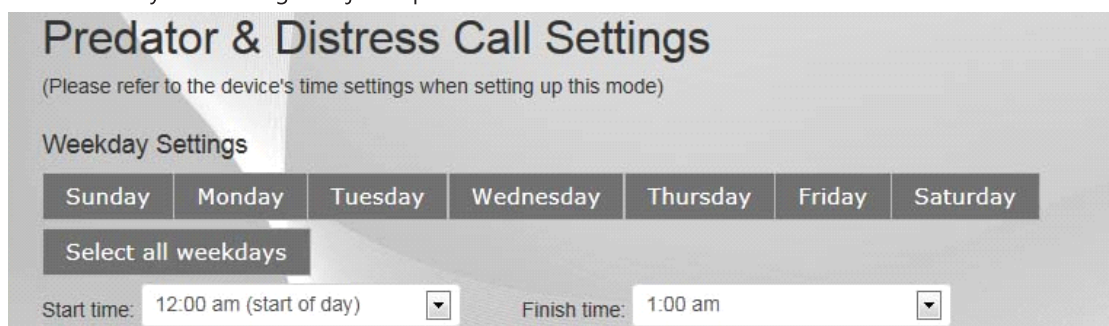

**1-877-4-NO-BIRD**  
**www.pigeonpatrol.ca**



### Setting of the Bird or Animal Choice:

1. Select the desired Bird or Animal choice. The choice will be highlighted.  
(These are the distress and predator sounds that everyone can hear.)

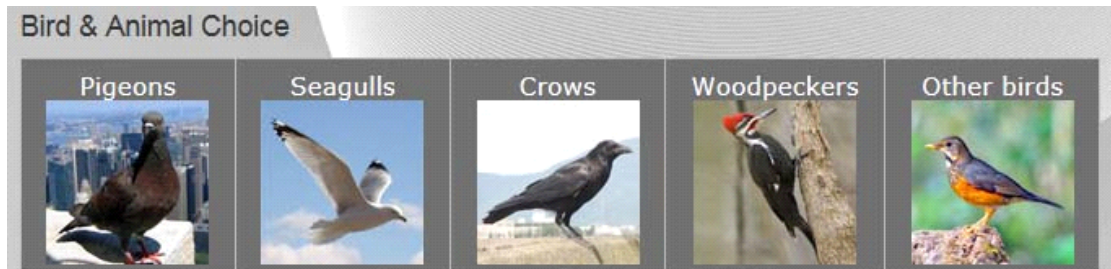

### Sound Frequency Setting:

1. Select the desired frequency setting. The choice will be highlighted.

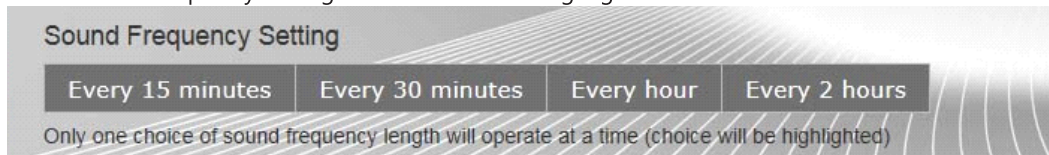

### Volume Control, Volume Testing and Apply Settings:

1. Select the volume you would like by clicking on the bar or sliding the tab to the right or left.
2. By pushing the **Test Volume** soft music will show you what the volume is set at.  
(Soft music was used due to the high pitched sound that are used to scare the animals and birds.) It can be loud.
3. Push the stop button to stop testing the volume. (You can test the volume as many times as you want.)
4. Pushing the **Play Selected Sound Now** button will allow you to hear the sounds associated with the bird or animal that you are trying to deter.
5. Pushing the **Apply Settings** button will allow you to save all of the settings (date and time, weekday settings, start and finish time, bird or animal choice, sound frequency and volume control for the sounds associated with the bird or animal that you are trying to deter. On the left of the screen the words (Device Config Setting Saved) will appear telling you that your settings have been saved.

**Note: If you do not want to use these sounds and just want to use the Unit for the UltraSonic sounds, set the Volume at zero (0) and select the **Apply Settings** again.**

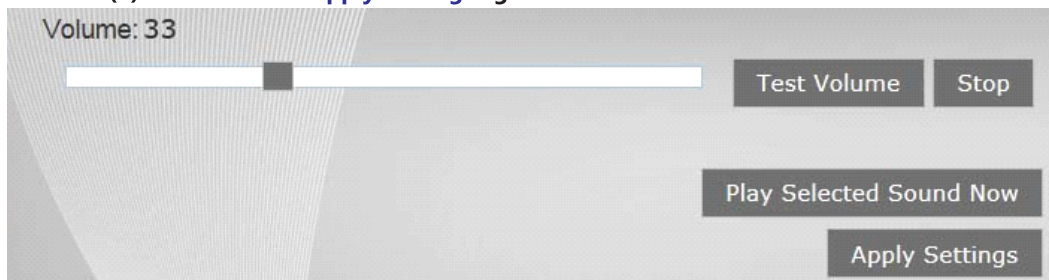

### UltraSonic Settings:

1. Push the **Off** button to turn off the UltraSonic Sounds.
  2. Push the **On** button to turn on the UltraSonic Sounds.
- UltraSonic sounds will play together with any bird or animal sound, or can be played on it's own.

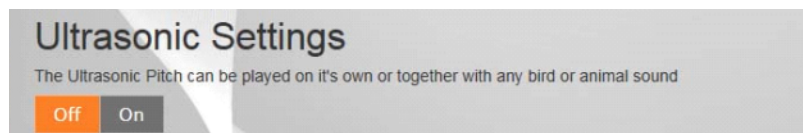





### UltraSonic Pitch Setting:

Select the desired UltraSonic Pitch that you would like to have the unit on. Your choice will be highlighted. (Note: 8kHz to 16.7kHz most small children and teenagers and some adults will be able to hear. The most common settings for deterring birds and animals will be between 17.7kHz and 24kHz. Listening or being around Ultrasonic sounds for long periods of time, may result in headaches.)

UltraSonic Pitch

8kHz	10kHz	12kHz	14kHz	14.9kHz	15.8kHz	16.7kHz
17.7kHz	18.8kHz	19.9kHz	21.1kHz	22.4kHz	24kHz	

Only one choice of Ultrasonic Pitch will operate at a time (choice will be highlighted)

### Volume Control, Volume Testing and Apply Settings:

1. Select the volume you would like by clicking on the bar or sliding the tab to the right or left.
2. By pushing the **Test Volume** you will be able to hear the Ultrasonic sound that was chose.  
(You can test the Volume as many times as you want.)
3. Pushing the **Apply Settings** button will allow you to save the UltraSonic settings only.

**Note: If you do not want to use the UltraSonic Pitches, just turn the settings to off.**

Volume: 66

Test Volume

Apply Settings

### Shutdown:

Push the **Shutdown Unit** button to shut down the entire unit.

**Note: Your settings will always be saved until you plug the unit back in. You will have to set the time and date again once you start up the unit again.**

Please wait at least 30 seconds for the unit to shutdown before removing the plug. Remember this is a computer that is inside and it does need time to shutdown.

**The light on the back of the unit will not turn off. It is used to indicate power only.**

Just unplugging the unit may result in corrupting the programme. It will also void your warranty.

On the bright side if you do have a power fail or a power surge or unplug the unit and corrupt the programme, just call us and tell us what happened and we will gladly send you the programme via e-mail and instructions on how to replace the SD card inside the unit.

### Last Thing:

Remember to disconnect from the UltraSonic Wi-Fi and reconnect to your regular provider or simply walk away to about 10 metres and the connection will drop off. You will not be automatically connected again. You will have to follow linking up to the unit steps to reconnect to the UltraSonic Wi-Fi network.

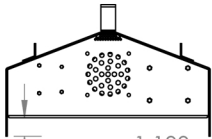
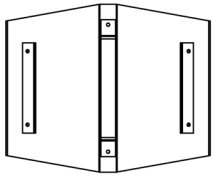

1.100  
Lid extends beyond  
base to keep out  
of standing water

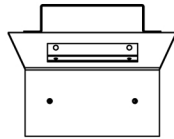

Handle and brackets for hanging are  
riveted on and powder coated  
as one unit

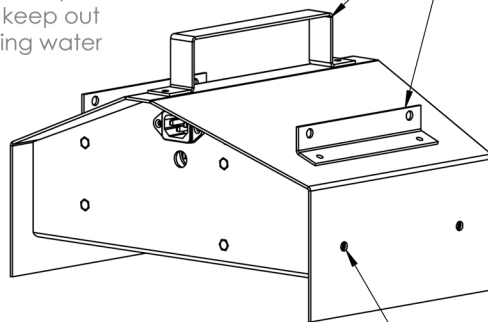

4 1/4" machine screws to  
secure cover to base

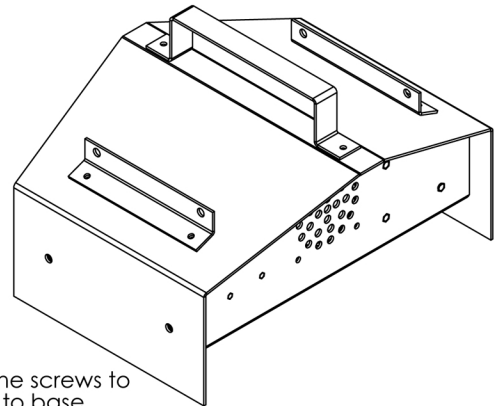

Base Dimensions (No cover)

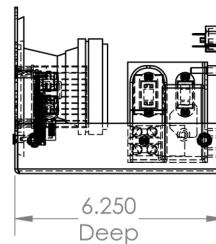
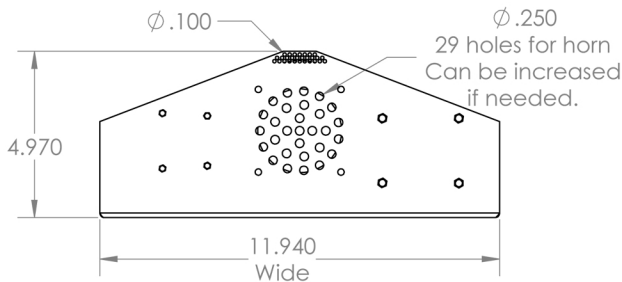

125VAC Power  
Bracket Assembly  
Mounted as unit.

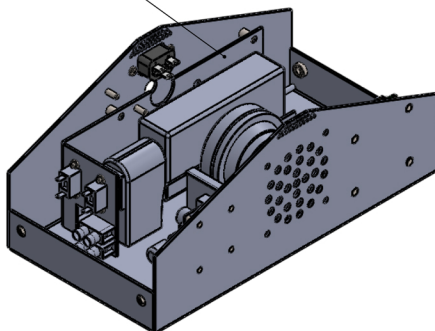

Raspberry Pi PCB  
Direct mount to  
side

Venting .100" holes  
Front & Back

Sound Card PCB  
Direct mount to  
side.

1/4-20 nuts to  
secure cover

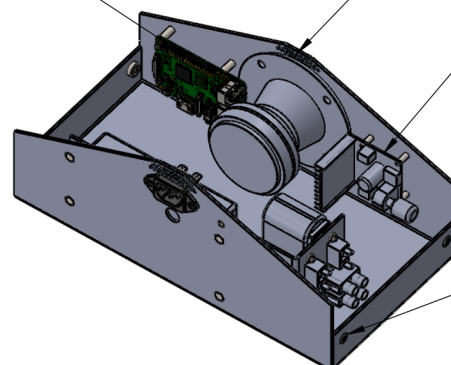

**1-877-4-NO-BIRD**  
**www.pigeonpatrol.ca**

